

# Akida PCIe Board User Guide

Version 1.0.1, document revision: g March 2022

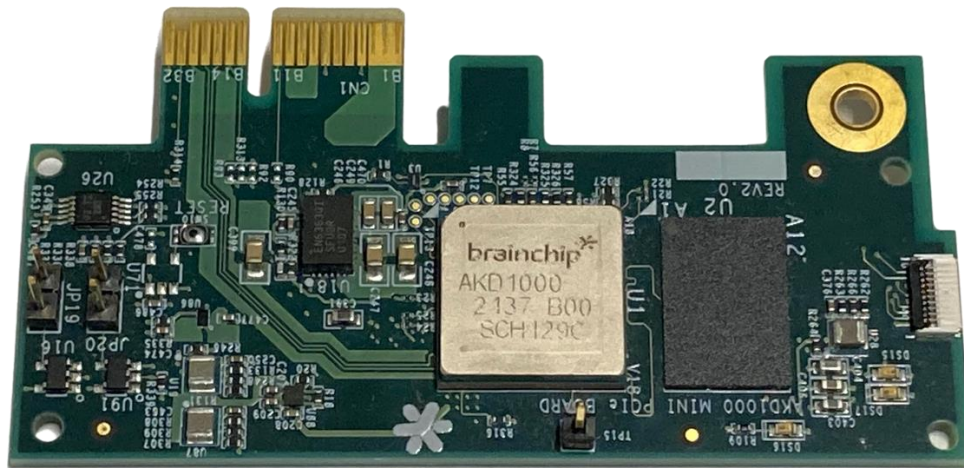

## Table of contents

|          |                                       |          |
|----------|---------------------------------------|----------|
| <b>1</b> | <b>INTRODUCTION .....</b>             | <b>3</b> |
| <b>2</b> | <b>INSTALLATION STEPS .....</b>       | <b>4</b> |
| 2.1      | REQUIREMENTS.....                     | 4        |
| 2.2      | INSTALL THE BOARD .....               | 4        |
| 2.3      | INSTALL THE DRIVER .....              | 5        |
| 2.4      | INSTALL AKIDA .....                   | 5        |
| <b>3</b> | <b>TROUBLESHOOT.....</b>              | <b>6</b> |
| 3.1      | RUNNING ISSUE .....                   | 6        |
| 3.2      | LSPCI GIVES NO RESULTS .....          | 6        |
| 3.3      | ERROR WHEN CHECKING THE PCIE BUS..... | 6        |

## 1 INTRODUCTION

The Akida Board Evaluation Kit is a one-lane PCIe board, for Akida technology assessment. It includes the AKD1000 Akida processor from Brainchip.

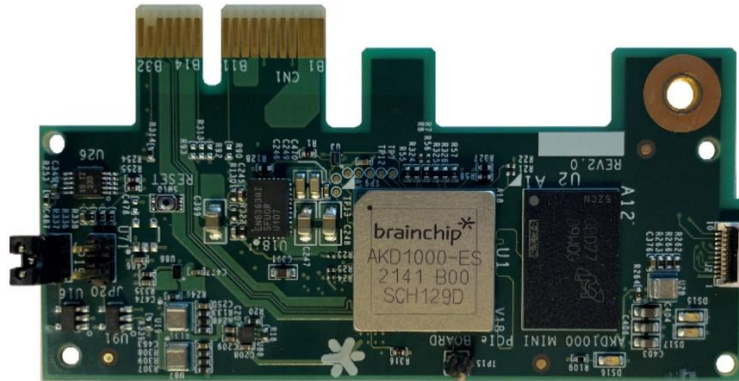

Figure 1: Akida PCIe card

Akida Board Evaluation Kit content and description:

- Akida PCI Express Reference Board
- Bracket and screw

## 2 INSTALLATION STEPS

---

### 2.1 REQUIREMENTS

#### Computer

An x86-64 PC architecture, such as any intel, i5, i7, i9 based computer.  
 Or an aarch64 machine architecture such as a Raspberry Pi 4 (IO mother board + CS daughter board).

#### OS

Linux Ubuntu 16.04, 18.04 and 20.04

#### Slots

A one-lane PCIe slot available

### 2.2 INSTALL THE BOARD

Depending on your computer, you may need to prepare the board, screwing the bracket onto the board. **Important:** Power down your computer before installing the board.

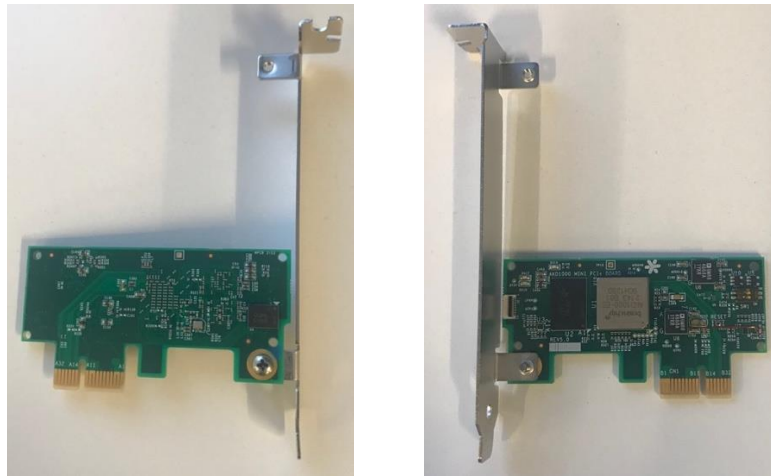

Figure 2: A board with its bracket

Then insert the board in the PCIe slot



Figure 3: A board plugged on a x86 PC and on a Raspberry Pi

#### Note

- The Akida PCI board is one-lane it can fit into a 2-,4- or 8-lines slot therefore it is important to pay careful attention when installing it. If it is improperly installed the board could be damaged.
- Brainchip Akida PCIe board is small, and it may appear that the ‘front’ part of the board is the wider than the “back” part, but it is not. See figure 3 notice the board “back” part extends past the PCIe connector this is the proper way to insert the board.

### 2.3 INSTALL THE DRIVER

In order to install Akida board PCIe Driver:

- Get the zipped driver from Brainchip
- Unzip it
- Follow the instruction you will find in the **README.md** file located in the unzipped folder.

### 2.4 INSTALL AKIDA

MetaTF development details can be found at <https://doc.brainchipinc.com/index.html>



## 3 TROUBLESHOOT

---

### 3.1 RUNNING ISSUE

If the system is stuck or if your applications do not run after performing the required steps in this user guide reboot the system.

### 3.2 LSPCI GIVES NO RESULTS

If, when entering:

```
lspci
```

at the command prompt, nothing is displayed.

Your Akida board may be wrongly inserted into bus slot.

Do the following

- Turn your machine totally off.
- Unplug and then plug back your Akida board into the PCI bus.
- Restart your machine.

### 3.3 ERROR WHEN CHECKING THE PCIE BUS

If you experience this error “*RuntimeError: unexpected transfer len: 1 expected: 4*” when running the command “akida devices” or when running akida demos run the provided “resetpcie.sh” script and retry.